

# TECH▲TIP

**Improved weather sealing of the wiper motor (P/N - 130198) on the 6K, 8K and 10K Telehandlers.**

**Tools Needed:**

General Hand tools

**Model:**

**GTH636, GTH844, GTH1056**

**Genie**<sup>®</sup>  
A TEREX BRAND

**TECH▲PRO**<sup>™</sup>

SERVICE AND TECHNICAL TRAINING

# TECH-TIP

## Tech Tips Safety Rules



### **Danger**

Failure to obey the instructions and safety rules in the appropriate Operator's Manual and Service Manual for your machine will result in death or serious injury. Many of the hazards identified in the operator's manual are also safety hazards when maintenance and repair procedures are performed.

### **Do Not Perform Maintenance Unless:**

- You are trained and qualified to perform maintenance on this machine.
- You read, understand and obey:
  - manufacturer's instructions and safety rules
  - employer's safety rules and worksite regulations
  - applicable governmental regulations
- You have the appropriate tools, lifting equipment and a suitable workshop.

The information contained in this tech tip is a supplement to the service manual. Consult the appropriate service manual of your machine for safety rules and hazards.

# TECH-TIP

## Step 1

The service Kit can be purchased through Genie Service Parts under part number -1280394GT



## Step 2

Disassembly of the unit.

- 1- Disconnect the battery of the machine.
- 2- Disconnect the power cable by separating the 4 pin Deutsch connector.
- 3- Unscrew the hex nut and washer from the wiper arm shaft and remove the wiper arm.

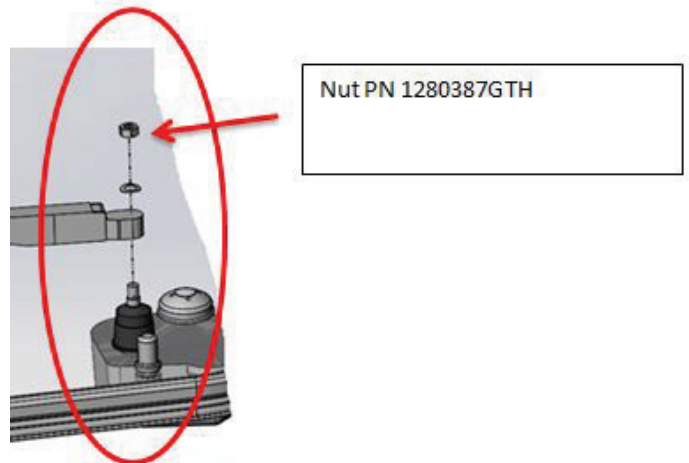

# TECH-TIP

## Step 3

Disassembly continued

4- Remove the main securing hex nut and separate the motor assembly from the windshield.



## Step 4

Assembly

5- Install the new windshield sealing decal.



# TECH-TIP

## Step 5

6- Install the new spacer and washer to the securing shaft.

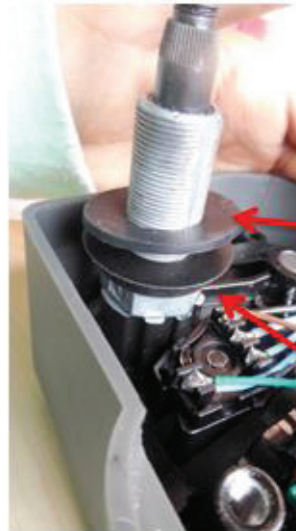

Rubber washer PN 1280385

Inside spacer PN 1280389

## Step 6

7- The outer washer and spacer OD was increased in an attempt to stop the rubber washer edge from rolling over.



# TECH-TIP

## Step 7

8- Secure the motor assembly against the newly fitted sealing decal already fitted to the windshield

9- Install the rubber seal, spacer, hex nut and torque hex nut to 6.5ft-lb.

10- Install nut cover.

11- Reconnect the 4 pin Deutsch connector into the electrical harness

12- Reconnect the battery.

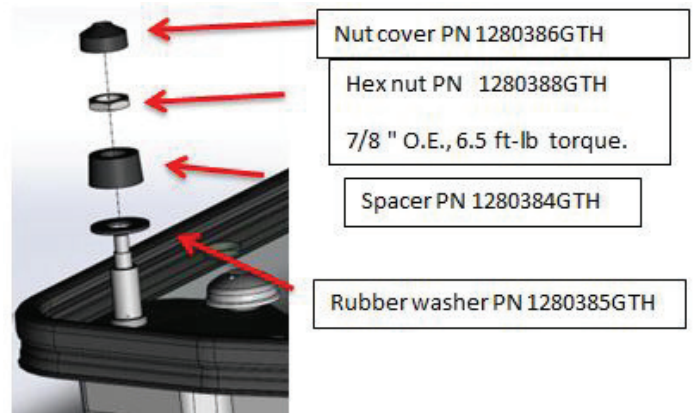

## Step 8

13- Install the wiper arm and secure the washer and hex nut and torque to 11ft-lb.

14- Test the wiper assembly for correct operation including speed control ensuring no excessive movement of the assembly.

